

REV.	ECN NO	LOCATIONS	DESCRIPTION	DATE	REVISER	APPD

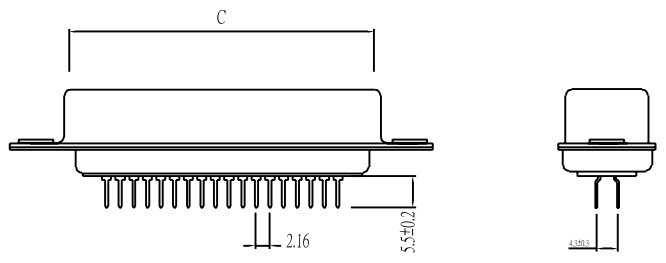
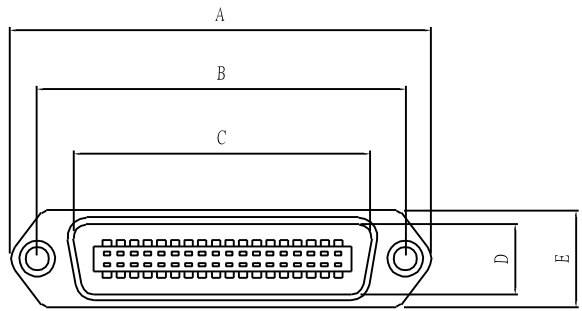

Note:

1.Material:

1.1 Insulator: High temperature thermoplastic with g.f,UL94v-0

1.2 Contact: Copper alloy,t=0.25mm

1.3 Shell: Spcc,t=0.40mm,50P Front-shell t=0.60mm

2.Specification:

2.1 Current rating: 1 A Max.

2.2 Dielectric withstanding voltage: 750 V(ac) for 1 min.

2.3 Contact resistance: 30 mΩ Max.

2.4 Insulation resistance: 1000 MΩ Min.

2.5 Total mating force: 9.0 Kgf Max.

2.6 Total unmating force: 5.0 Kgf Min.

2.7 Temperature range: -55°C~85°C

8	Back-shell			
7	Front-shell			
6	Clip			No finish
5	Contact			Selective Au plated on mating area
4	Contact			
3	Contact			
2	Contact			
1	Housing			Black
No.	Name	Q'ty	Part No.	Finish

PART NO.	A±0.2	B±0.2	C±0.2	D±0.13	E±0.2
PNE01-14P	43.9	36.0	25.5	12.25	15.3
PNE01-24P	54.7	46.8	36.3	12.25	15.3
PNE01-36P	67.7	59.7	49.3	12.25	15.3
PNE01-50P	82.8	74.9	64.4	12.25	15.3

PART NO:		MATERIAL:			
MODEL NO:		FINSH:			
UNIT: mm	SIZE:	COLOR:		PART NAME:	
TOLERANCE UNSPECIFIED		DR: <i>YuHong</i>		CENTRONIC (Male)P.C.B Standard	
.x ±0.3	.xx ±0.20	CHK: <i>Nick</i>		DWG NO: PNE01-M	REV: AO
.xxx ±0.100	ANG. ±1°	APP: <i>Kent</i>		SCALE: 1:1	SHEET: 1 of 1



REV.	ECN NO	LOCATIONS	DESCRIPTION	DATE	REVISER	APPD

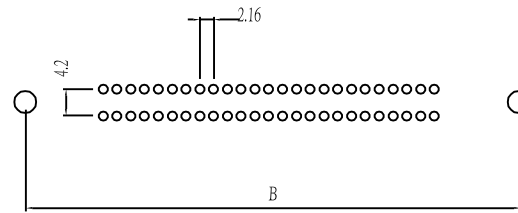
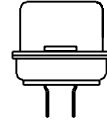
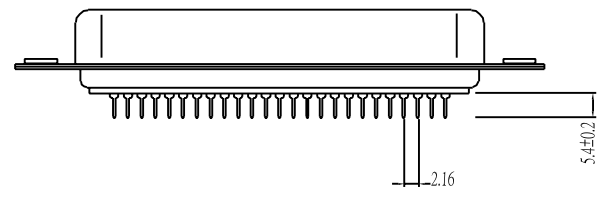
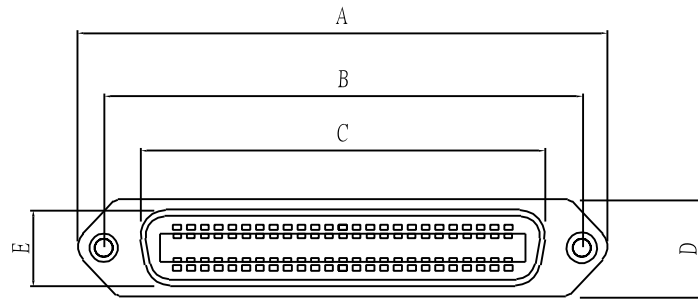

Note:

1.Material:

- 1.1 Insulator: High temperature thermoplastic with g.f,UL94v-0
- 1.2 Contact: Copper alloy,t=0.25mm
- 1.3 Shell: Spcc,t=0.40mm,50P Front-shell t=0.60mm

2.Specification:

- 2.1 Current rating: 1 A Max.
- 2.2 Dielectric withstanding voltage: 750 V(ac) for 1 min.
- 2.3 Contact resistance: 30 mΩ Max.
- 2.4 Insulation resistance: 1000 MΩ Min.
- 2.5 Total mating force: 9.0 Kgf Max.
- 2.6 Total unmating force: 5.0 Kgf Min.
- 2.7 Temperature range: -55°C~85°C

8	Back-shell			
7	Front-shell			
6	Clip			No finish
5	Contact			Selective Au plated on mating area
4	Contact			
3	Contact			
2	Contact			
1	Housing			Black
No.	Name	Qty	Part No.	Finish

PART NO.	A±0.2	B±0.2	C±0.2	D±0.03	E±0.2
PNE01-14S	43.92	35.99	25.2	12.25	11.9
PNE01-24S	54.71	46.79	36.0	12.25	11.9
PNE01-36S	67.69	59.74	48.9	12.25	11.9
PNE01-50S	82.78	74.85	64.0	12.25	11.9

PART NO:		MATERIAL:			
MODEL NO:		FINISH:			
UNIT: mm	SIZE:	COLOR:		PART NAME:	
TOLERANCE UNSPECIFIED		DR: <i>YuHong</i>		CENTRONIC (Female)P.C.B Standard	
.x ±0.3	.xx ±0.20	CHK: <i>Nick</i>		DWG NO: PND01-F	REV: A0
.xxx ±0.100	ANG ±1'	APP: <i>Kent</i>		SCALE: 1:1	SHEET: 1 of 1

